

**POLE MOUNTED FIXTURE TYPE "S1"**

THE POLE CONCRETE BASE DETAIL IS SHOWN FOR ELECTRICAL ROUGH-IN AND SHALL NOT BE USED FOR THE ACTUAL BASE CONSTRUCTION. POLE BASE SHALL BE DESIGNED BY A REGISTERED STRUCTURAL ENGINEER AND CONSTRUCTED PER STRUCTURAL ENGINEERS SEALED CONSTRUCTION DOCUMENT.

NOTE: BASE OF LIGHT POLE TO BE PAINTED TO MATCH BUILDING COLOR

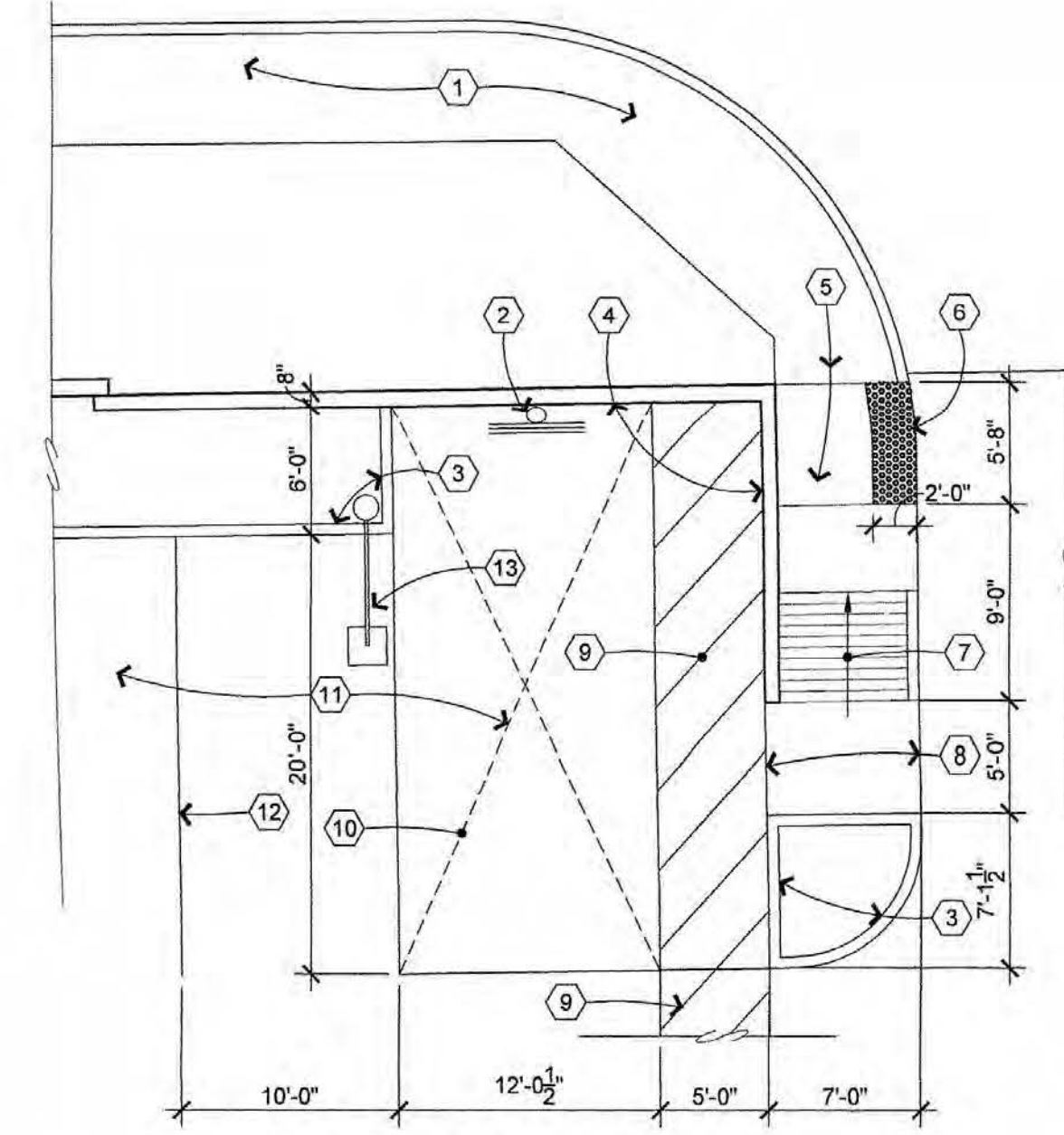

**BLOW-UP PLAN @ PASSENGER LOADING AREA**  
SCALE: 1/8" = 1'-0"

**BLOW-UP PLAN @ PASSENGER LOADING KEYNOTES:**

1. 6'-0" wide existing concrete sidewalk
2. Signage: "PARKING ONLY FOR PASSENGER LOADING AREA"
3. 6" C.I.P. concrete curb per Civil drawings.
4. 3'-0" high, 8" cmu screenwall
5. 4" concrete sidewalk
6. 2'-0" wide truncated domes
7. Ramp up 1:12 max slope with score joints per 2010 ADA standards.
8. Concrete sidewalk flush with asphalt pavement
9. 4" wide yellow painted diagonal striping at 24" o.c. and at perimeter.
10. 12' x 25' passenger loading area
11. Asphalt pavement per Civil drawings
12. 4" wide parking stripe
13. Light pole per electrical drawing

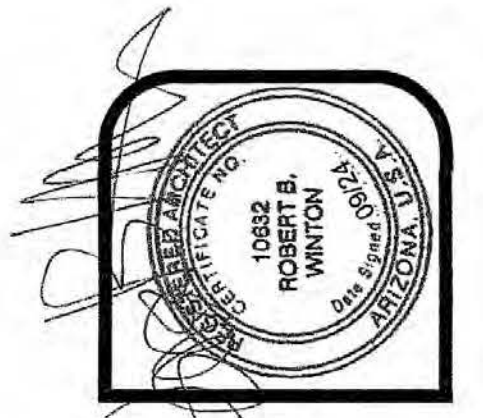

**winton architects, inc.**  
Phoenix, Az. 85014  
1435 E. Rancho Drive  
(602) 230-9778  
wintonarch@gmail.com

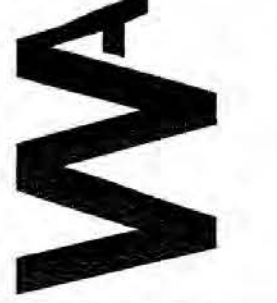

**A NEW BUILDING FOR: KIWAMI ON BELL**  
5327 W. BELL ROAD  
GLENDALE, ARIZONA 85306  
LOGOS BUILDERS SOUTHWEST

job no. 24114  
drawn LB  
approved RBW  
date 9/25/24

revisions

**SP-3**